

Hatten Land unveils plans for US\$49.2m Melaka's largest water theme park

News Stories

Wed, Aug 8, 8:27 AM

Back

Investor-One

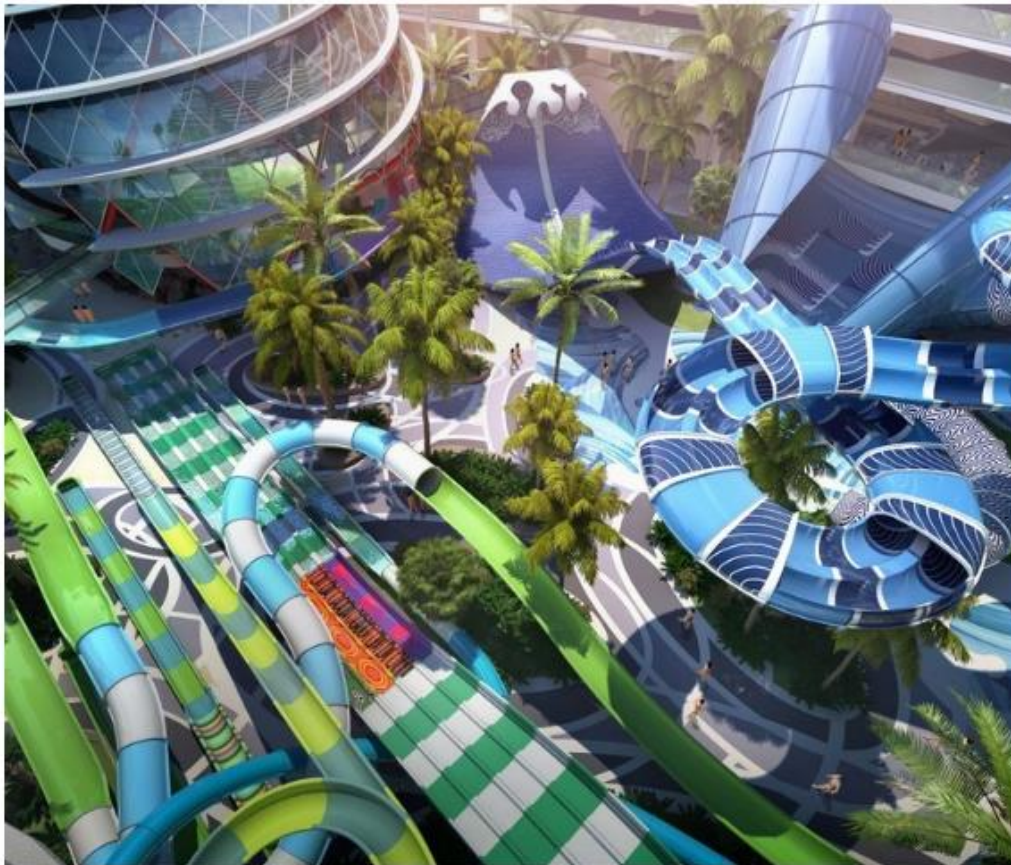

Artist's impression of the water theme park SOURCE: HATTEN LAND

Catalist-listed Hatten Land Limited has, together with leading resort operator Samsung C&T Corporation and the world's leading designer and installer of water slides Polin Waterparks, unveiled plans to build a RM200 million (S\$67.03 million) water theme park, the largest in Melaka.

Referred to as the world's first 'sky' theme park, it is intended to be "catalyst for the Malaysian historical city's tourism industry".

Chief Minister of Melaka Adly Bin Zahari witnessed the signing ceremony on Tuesday (Aug 7) among the three parties to build Splash World @ Harbour City, a 500,000-sq ft water park to be located 14 floors above the ground in the centre of the designated UNESCO World Heritage city, which hosts nearly 17 million visitors a year.

In a filing to the Singapore Exchange on Tuesday (Aug 7), Hatten Land said the waterpark is due to be completed by end-2019 and expected to be opened to the public in the first half of 2020. Splash World @ Harbour City will be one of the region's largest water parks with up to 5,200 visitors a day.

Splash World @ Harbour City hopes to attract 850,000 to 1.0 million visitors annually after the first year of operation. The theme park may also extend the average length stay and increase the average spending a day, which bodes well for the tourism sector. It has an estimated development cost of RM200 million (USD49.2 million).

Hatten Land, listed will be developing the project, while Samsung C&T Corporation of South Korea will be operation advisor and consultant. Polin Waterparks, headquartered in Turkey, will design and manufacture the water slide attractions.

Nestled between two 30-storey towers on the 14th floor deck of Harbour City @ Melaka, a mixed development shaped like a large ship, the four-storey Splash World @ Harbour City will be the first 'in the sky' theme park that will offer an indoor and outdoor waterpark experience with more than one kilometre of water slides.

A manmade river will meander over two floors to intertwine more than 50 attractions, including 11 extreme slides for thrill-seekers, a Sky Beach, and a dedicated children's water play park. After dark, the Cosmic Waters light show will light up the park, accompanied by a water circus, trapeze stunts and other entertainment in a special amphitheatre.

Hatten Land said the scale and concept of the project will reshape tourism in Melaka.

Chief Minister Adly Zahari said: "Melaka is rich in historical significance not just for Malaysia but the whole of Southeast Asia. Splash World @ Harbour City will bring a transformational new dimension to our travel and leisure landscape and make Melaka an even more compelling international attraction."

"The impact of this project will resonate beyond tourism to the broader economy, creating new jobs and opportunities for international economic partnerships and even direct investments," he added.

Executive Chairman and Managing Director of Hatten Land Colin Tan said: "Splash World @ Harbour City is a hugely important project which underscores Hatten Land's commitment to the long-term development of Melaka. We are partnering world-renowned leaders in their respective fields – Samsung C&T Corporation and Polin Waterparks – to place Melaka on the world map as a must-visit destination. We are grateful to the Government of Melaka and the Malaysian authorities for their support of this project."

Samsung C&T's resort group is the owner and operator of South Korea's popular Everland Resort, which hosts 8 million visitors per year. Everland Resort consists of the Everland theme park, which integrates attractions, shows, zoos, and gardens, as well as the Caribbean Bay waterpark, which features world-class facilities and services. It is a leading global operator and service provider for resorts, as well as golf courses, food supply and landscaping.

General Manager of Everland Resort and Executive Vice President of Samsung C&T Tommy Byungsuk Jeong said: "Riding on our success with the Everland and Caribbean Bay resorts, we are pleased to offer our services and operational expertise in this new venture with Hatten's Splash World @ Harbour City. This is our first foray into Malaysia and we are optimistic about future growth in Melaka's tourism industry."

Polin Waterparks is a multi-award-winning global leader in the design, production, engineering and installation of waterparks and water slides that incorporate efficient smart design features. With a track record of 3,000 waterpark projects in 105 countries, it is the largest water slide supplier to waterparks in Eurasia.

Its Regional Sales Director Emre Büyükgüngör added: "Splash World @ Harbour City is an exciting new destination for Malaysia and one of the region's few major waterparks. Polin Waterparks is honoured to be appointed to design and install Hatten's choice of hybrid ride designs to create a one-of-a-kind experience for Splash World's guests."